

**TECHNICAL DATA**

LOAD.....	3.2t
SPAN.....	28.5m
LIFTING HEIGHT.....	8.5m
HOISTING SPEED.....	5/0.8 m/min 2-SPEED
TRAVERSING SPEED.....	0-20 m/min STEPLESS
TRAVELLING SPEED.....	0-32 m/min STEPLESS
WEIGHT OF TROLLEY.....	0.27t
WEIGHT OF CRANE.....	7.9t
POWER SUPPLY.....	380V/48V/50Hz
CRANE GROUP.....	FEM A3
HOIST GROUP.....	M5(FEM 2m)
BRIDGE TRAVEL GROUP.....	M3(FEM 1Am)
SUPPLY POWER.....	5.65kW
TOLERANCES ACC. TO ISO/FEM STANDARD	
BRIDGE PAINT:	E120/RAL1028
DRAWING NOT IN SCALE	

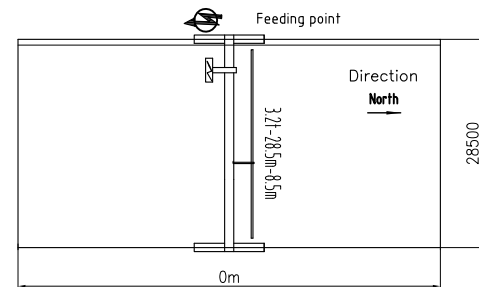

PRELIMINARY DRAWING OFFER ONLY.

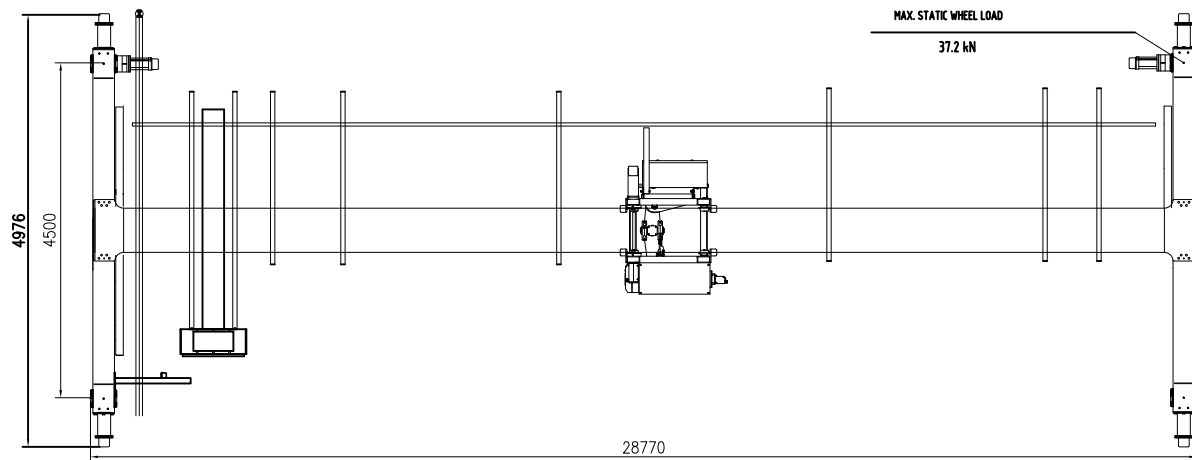

						Name			RU02		
						Material code			Part Name		
Rev.	Pcs.	Area	Mod.Index	Modified	Date						
Designed	RU02	2023/11/30	Standardized			Stage	Weight(Kg)	Issue	KS3.21x28.5m x 8.5m-A3		
Checked			Approved		2023/11/30		7900	A0			
Verified		2023/11/30				Size					
Processed			Scale	1:35	A2	Total	Page		DWG No.		